

2.4G LED RGBW Controller



Main Characteristics

V4 RF RGBW Remote Control

Remote Option:	RGBW
Working Voltage:	3Vdc (Battery CR2032)
Wireless Frequency:	2.4GHz
Working Temperature:	-30°C~55°C
Package Size:	L150×W46×H18(mm)
Weight(G.W.):	85g

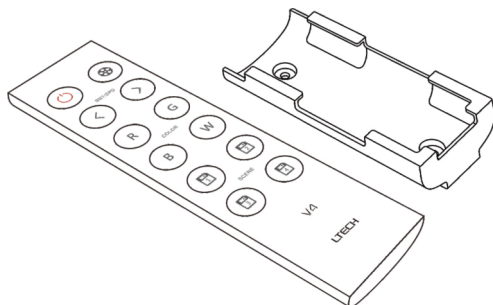

R4-3A CV Receiver

Input Voltage:	5~24Vdc
Max Current Load:	3A × 4CH Max. 12A
Max Output Power:	60W/144W/288W(5V/12V/24V)
Working Temperature:	-30°C~55°C
Package Size:	L127×W35×H24(mm)
Weight(G.W.):	60g

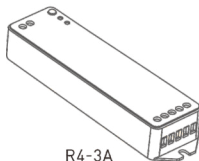

R4-3A

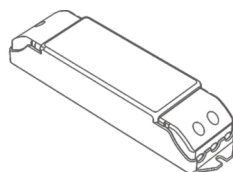

R4-5A/R4-CC

R4-5A CV Receiver

Input Voltage:	5~24Vdc
Max Current Load:	5A × 4CH Max. 20A
Max Output Power:	100W/240W/480W(5V/12V/24V)
Working Temperature:	-30°C~55°C
Package Size:	L178×W48×H33(mm)
Weight(G.W.):	150g

R4-CC CC Receiver

Input Voltage:	12~48Vdc
Output Voltage:	3~46Vdc
Output Current:	CC 350/700/1050mA×4CH
Output Power:	1.05W~48.3W×4CH Max 193.2W
Working Temperature:	-30°C~55°C
Package Size:	L178×W48×H33(mm)
Weight(G.W.):	165g

Note: Receiver is sold separately.

Dimensions

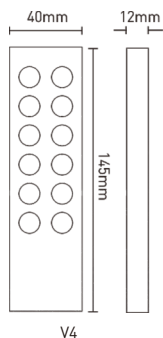

V4

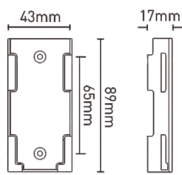

Holder

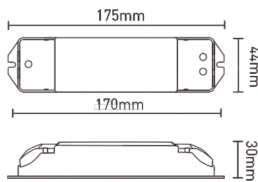

R4-5A/R4-CC

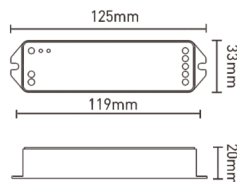

R4-3A

Operating Instruction for Remote:

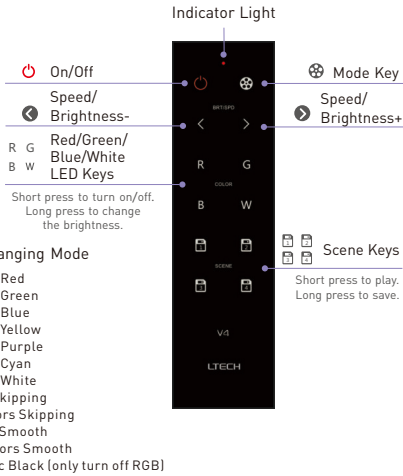

The Changing Mode

1. Static Red
2. Static Green
3. Static Blue
4. Static Yellow
5. Static Purple
6. Static Cyan
7. Static White
8. RGB Skipping
9. 7 Colors Skipping
10. RGB Smooth
11. 7 Colors Smooth
12. Static Black (only turn off RGB)

Match/Clear code between remotes

Match code:

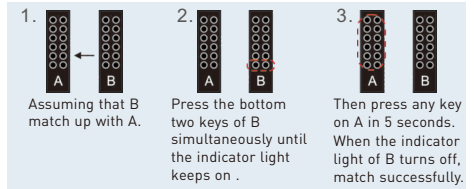

Clear code:

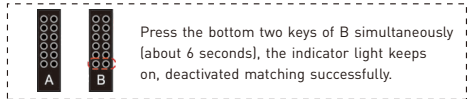

Match/Clear code between remote and receiver

Match code:

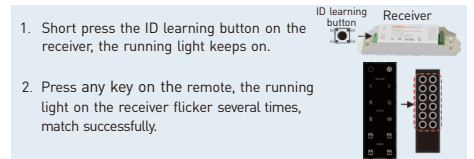

Clear code:

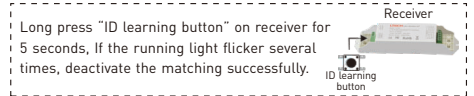

Operating Instruction for Receiver:

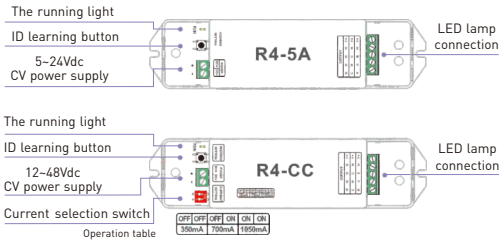

Wiring Diagram :

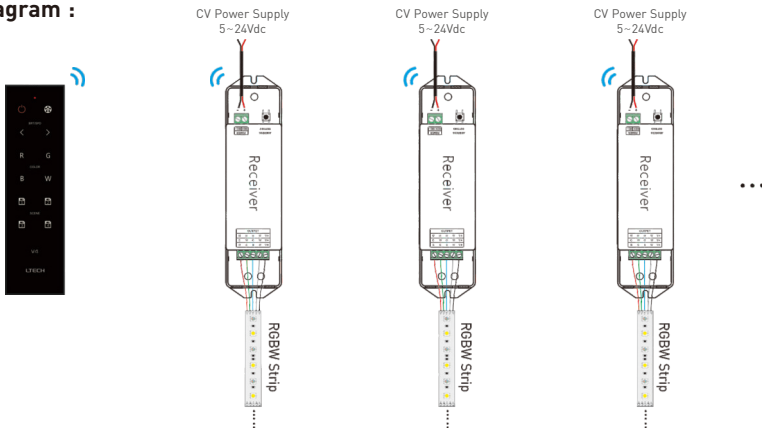

Attention:

- Please replace the battery if the remote becomes insensitive or control distance is shortened.
- Please take out the battery for long time unused.