

START

1

Resistor - Weerstand - Résistance - Widerstand - Resistencia - Motstand - Vastus - Resistenze

- ◇ R1,R2: (Yellow, Purple, Orange) -(Geel, Paars, Oranje) -(Jaune, Violet, Orange) -(Gelb, Violet, Orange) -(Gel, Lila, Orange) -(Keltainen, Purppura, Oranssi) -(Amarillo, Morado, Naranja) -(Amarelo, Violeta, Laranja) -(Giallo, Viola, Aranciato)
- ◇ R3, ..., R14 : (Red, Red, Brown) -(Rood, Rood, Bruin) -(Rouge, Rouge, Brun) -(Rot, Rot, Braun) -(Röd, Röd, Brun) -(Punainen, Punainen, Ruskea) -(Rojo, Rojo, Marrón) -(Encarnado, Encarnado, Castanho) -(Rosso, Rosso, Marrone)
- ◇ R15 : 0 (Black) -(zwart) -(noir) -(Schwarz) -(Svart) -(Musta) -(Negro) -(Preto) -(Nero)

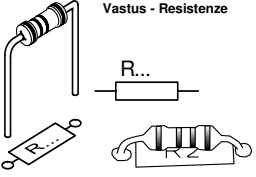

2

CAPACITOR

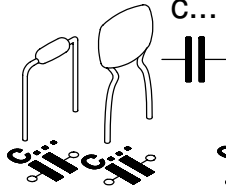

◇ C1 : 100nF (104) µ1

3

LEDs

- 0 : Yellow/Geel/Jaune/Gelb/Keltainen/Amarillo/Amarelo/Giallo
- 32,19,21,25,34,27,36,30,23,5,16,1,14,9,18,7,12,3 : Red/Rood/Rouge/Rot/Röd/Punainen/Rojo/Encarnado/Rosso
- 15,4,2,17,6,13,11,8,10,24,33,20,31,22,29,28,35,26 : Green/Groen/Vert/Grün/Grön/Vihreä/Verde

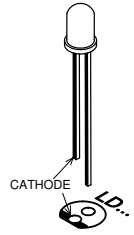

Watch the polarity !
Att. à la polarité !



4

PUSHBUTTON

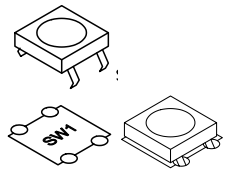

◇ SW1

5

IC SOCKET

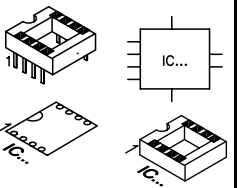

◇ IC1 : 14P
◇ IC2 : 6P

6

TRANSISTOR

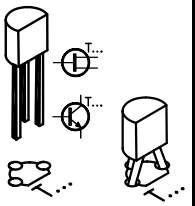

◇ T1 : BC557

7

BUZZER

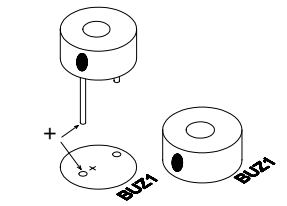

◇ BUZ1

8

BATTERY HOLDER

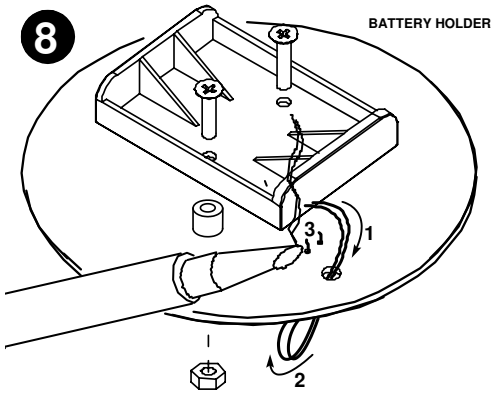

9

IC

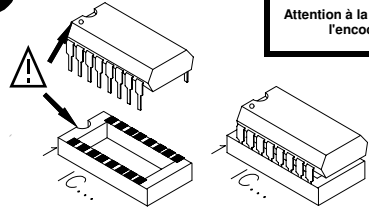

- ◇ IC1 : VMK119 (prog. PIC16C505)
- ◇ IC2 : 4N33 or eq.

